

First Floor
TUSCAN EXTERIOR DESIGN SHOWN

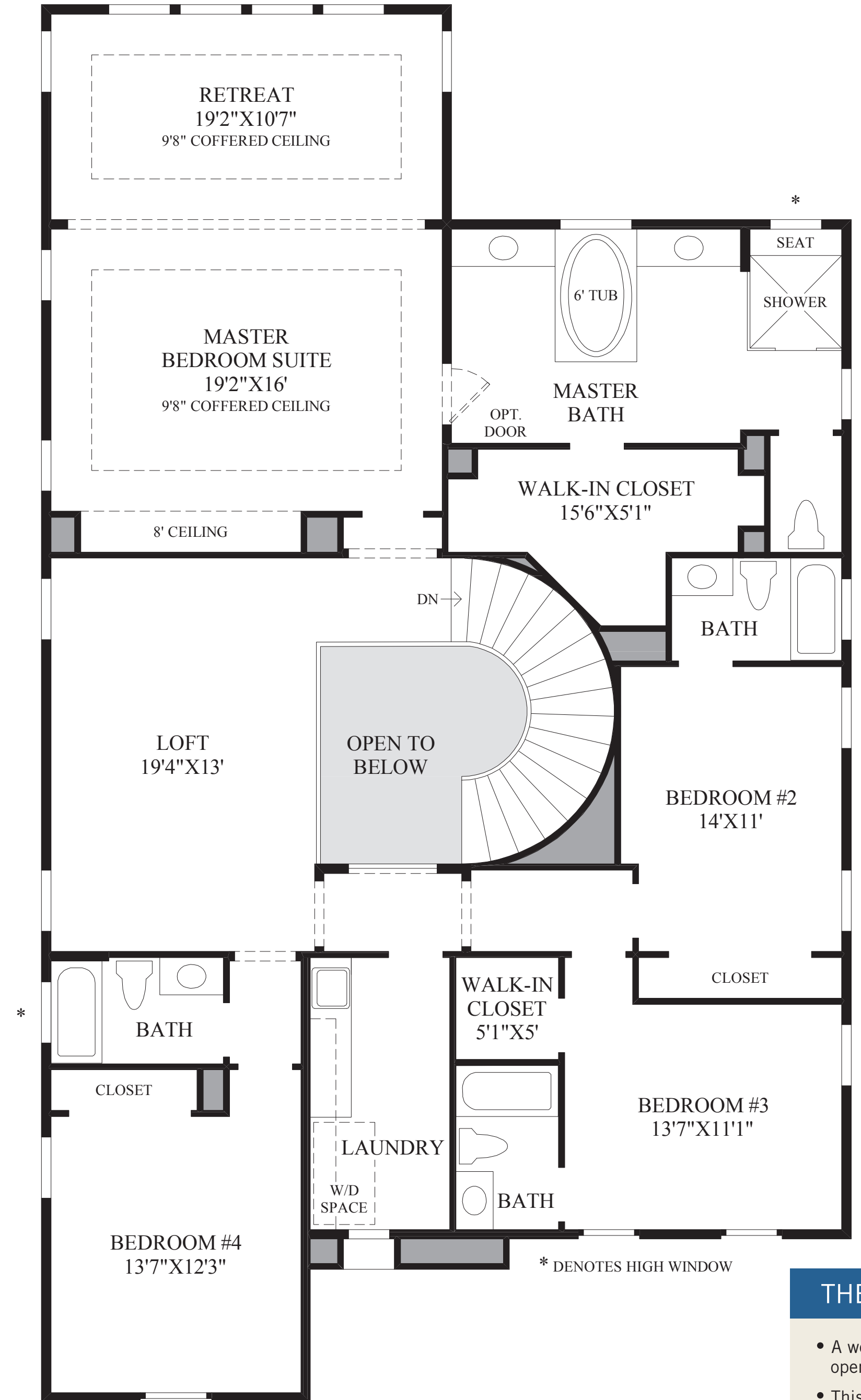

CLASIC AND SPANISH EXTERIOR DESIGNS INCLUDE BALCONY.

Second Floor

THE MORENO HIGHLIGHTS

- A welcoming covered entry adds curb appeal before opening up to a stunning open-concept home.
- This remarkable kitchen boasts a huge center island with a breakfast bar, a walk-in pantry, and a butler pantry that allows for discrete access to the formal dining room.
- An ornate curved staircase leads to a sizable loft that adds a secondary living space central to the upstairs bedrooms, creating a space that is ideal for multi-generation entertaining.
- Completing the impressive master bedroom suite are elegant coffered ceilings, a desirable retreat, a large walk-in closet, and a luxurious master bath.
- Additional highlights include a first-floor bedroom, a convenient laundry location, a full bath for each bedroom, and an expansive luxury outdoor living space that is complete with a radiant fireplace.